

Installation Instructions

GTx™ LED Traffic Signal Internal Masks

200mm (8in) and 300mm (12in) Circular Modules



BEFORE YOU BEGIN

Read these instructions completely and carefully.

WARNING

Risk of Electric Shock. Disconnect Before Servicing or installing product.

Prepare Electrical Wiring



Electrical Requirements

- Do not perform mask installation in wet locations
- Follow all National Electric Codes (NEC) and local codes.

IMPORTANT NOTICE: "Removal of the internal domed lens will **void your warranty.**"

- Always **WEAR** gloves.
- **DO NOT** touch the front shell or internal domed lens at ANY TIME without gloves.
- **ALWAYS** Rest the front shell on something soft, to prevent scratching.
- Avoid dropping or leaving any debris in the lamp when it is open.
- Failure to properly follow these instructions may cause the signal to malfunction.



Mask Installation Steps:

1. **Remove gasket:** Pull the gasket up and out.
2. **Turn lamp over:** Lay the front shell on a cushioned surface to avoid scratching or damaging the surface.

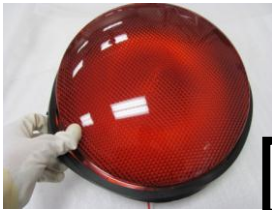

Step 1



Cushioned surface

Step 2

3. **Unclip lamp:** Insert a thin flathead screwdriver slightly to one side of a clip and pry it outward. Repeat until all 8 clips are undone.
4. **Remove front shell:** Place the lamp on its back housing and locate the back housing locating feature.





Step 3



Back housing locating feature

Step 4

5. For single piece masks  proceed to step 6. For two-piece arrow masks  go to step 7.

6. **Align mask:** Align the locating features on the mask and back housing, and place the mask on the back housing. The mask will not rotate if the locating features are aligned correctly. **Proceed to step 8.**



Mask locating feature

Step 6



Align the locating features on the mask & back housing

Step 6

Instructions for Single Piece Masks



Installation Instructions (cont'd)

GTx™ LED Traffic Signal Internal Masks

Instructions for
Two Piece
Arrow Masks



7. For two-piece arrow masks which consist of:

- the crown (the hollow circular plastic part)
- the arrow mask (the directional arrow which fits on top of the crown)

a. **Orient Crown:** Align the locating features on the crown and back housing. Place the crown on the back housing. The crown will not rotate if the locating features are aligned correctly.

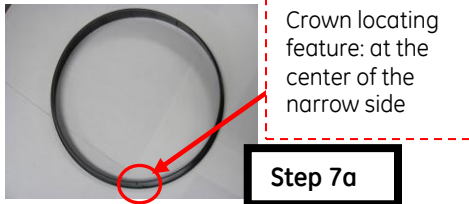

b. **Orient arrow mask:** Align the locating features on the mask (Arrow) and crown. There are 16 locating features to give orientation options for different directions. Once the appropriate direction is selected place the mask (Arrow) on top of the crown. The mask (Arrow) will not rotate if the locating features are aligned correctly.



8. **Close lamp:** Clip the front shell onto the back housing by aligning the locating features at the top of the back housing and the top of the shell, then squeeze the two together at each clip until you hear a click.

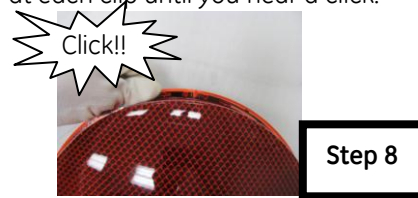

9. **Verify sealing:** Turn the lamp upside down to check that all 8 clips are engaged.

10. **Ensure proper sealing:** Squeeze the flange between the clips to completely seal the lamp.

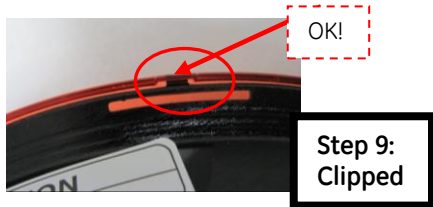

11. Reinstall the gasket (refer to Step 1).



NOTE: If you prefer to have this Installation Instructions document in **other languages**, visit our official website at: www.gelighting.com/installation



GE Lighting Solutions • 1-888-MY-GE-LED • www.gelightingsolutions.com
1-888-69-43-533 • or • +1.216.266.2419

GE Lighting Solutions, LLC is a subsidiary of the General Electric Company. GTx is a trademark of GE Lighting Solutions, LLC. The GE brand and logo are trademarks of the General Electric Company. © 2011 GE Lighting Solutions, LLC. Information provided is subject to change without notice. All values are design or typical values when measured under laboratory conditions.

TRAF203-R121712